

QWC-19200-31000

Broadband & High Isolation

Features:

- * Broadband
- * High Isolation
- * Low Insertion Loss

Applications:

- * Wireless
- * Radar
- * Laboratory Test

Electrical

Frequency:	19200~31000MHz
Insertion Loss:	0.4dB max.
Isolation:	18dB min.
VSWR:	1.3 max.
Forward Power:	10W
Reverse Power:	10W

Mechanical

Size:	30.0*30.0*22.4mm 1.181*1.181*0.882in
Interface:	WR-34 (BJ260)

Environmental

Temperature:	0~+30°C
--------------	---------

Outline Drawings

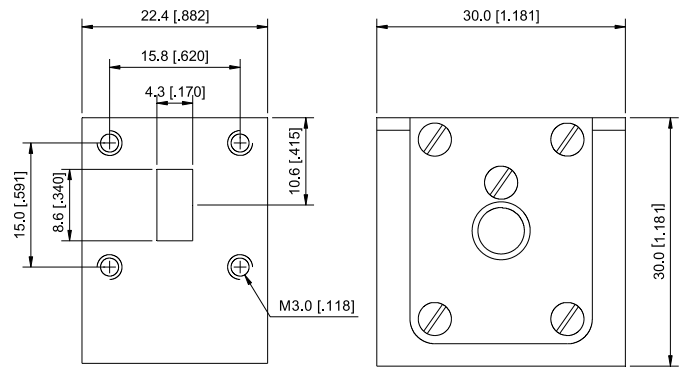

Unit: mm [inch]

Tolerance: ±0.2mm [±0.008in]

How To Order

QWC-19200-31000

Customization is available upon request.