

QWCA

High Power, High Isolation

Features:
 * High Power
 * High Isolation
 * Low Insertion Loss
 * Low VSWR

Applications:
 * Wireless
 * Radar
 * Laboratory Test

Description

QWCA series Waveguide Circulators cover frequency range 5400~8000MHz. High power, high isolation and low insertion loss make it ideal for a lot of applications like amplifiers, transceivers, etc.

Specifications

Part Number	Frequency Range (MHz)	Insertion Loss (dB, max.)	Isolation (dB, min.)	VSWR (max.)	Temperature (°C)
QWCA-5400-5900	5400~5900	0.3	23	1.15	-40 ~ +85
QWCA-5800-7100	5800~7100	0.4	18	1.3	-40 ~ +85
QWCA-6000-6500	6000~6500	0.3	23	1.15	-40 ~ +85
QWCA-6000-7700	6000~7700	0.4	18	1.3	-40 ~ +85
QWCA-7000-8000	7000~8000	0.35	20	1.2	-40 ~ +85
QWCA-7800-8000	7800~8000	0.25	25	1.12	-40 ~ +85

Power Handling

Forward Power: 100W
 Reverse Power: 100W

Mechanical

Size: 68.3*80.0*49.2mm
 2.689*3.150*0.622in
 Interface: WR-137 (BJ70)

How To Order

QWCA-X-Y

X: Start frequency in MHz

Y: Stop frequency in MHz

Examples:

To order a QWCA series circulator, 5400-5900MHz, specify QWCA-5400-5900.

Customization is available upon request.

Outline Drawings

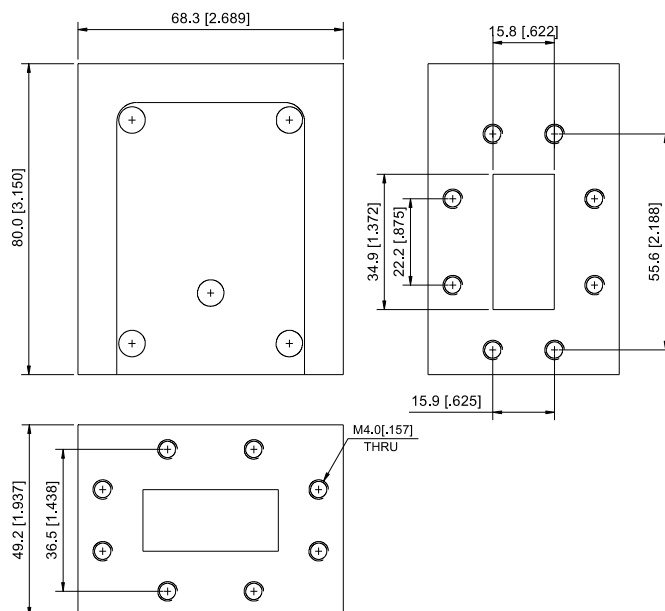

Unit: mm [inch]

Tolerance: $\pm 0.2\text{mm}$ [$\pm 0.008\text{in}$]