

QWID

High Power, High Isolation

Features:
 * High Power
 * High Isolation
 * Low Insertion Loss
 * Low VSWR

Applications:
 * Wireless
 * Radar
 * Laboratory Test

Description

QWID series Waveguide Isolators cover frequency range 10000~15000MHz. High power, high isolation and low insertion loss make it ideal for a lot of applications like amplifiers, transceivers, etc.

Specifications

Part Number	Frequency Range (MHz)	Insertion Loss (dB, max.)	Isolation (dB, min.)	VSWR (max.)	Temperature (°C)
QWID-10000-12000	10000~12000	0.3	23	1.2	-40 ~ +85
QWID-10000-11000	10000~11000	0.3	23	1.15	-40 ~ +85
QWID-10000-12750	10700~12750	0.3	23	1.2	-40 ~ +85
QWID-11000-12400	11000~12400	0.35	20	1.2	-40 ~ +85
QWID-12000-13800	12400~13800	0.35	20	1.2	-40 ~ +85
QWID-13750-14250	13750~14250	0.3	23	1.15	-40 ~ +85
QWID-14000-15000	14000~15000	0.3	23	1.15	-40 ~ +85

Power Handling

Forward Power: 100W
 Reverse Power: 30W
 Interface: WR-75 (BJ120)

Mechanical

Size: 44.5*57.2*38.1mm
 1.750*2.250*1.500in

How To Order

QWID-X-Y

X: Start frequency in MHz

Y: Stop frequency in MHz

Examples:

To order a QWID series Isolator, 10000-12000MHz, specify QWID-10000-12000.

Customization is available upon request.

Outline Drawings

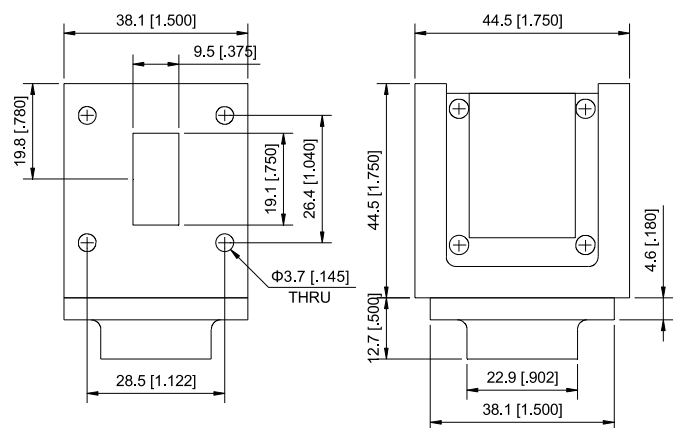

Unit: mm [inch]

Tolerance: ±0.2mm [±0.008in]